



**FITTING INSTRUCTIONS FOR LGFK0001 LEVER-GUARD FITTING KIT  
TO FIT HOLLOW BARS WITH INTERNAL DIAMETER OF 13-21mm  
ONLY**

Page | 1



PLEASE ENSURE THAT THIS PRODUCT WILL FIT BEFORE ANY REMOVAL OR MODIFICATIONS OF PARTS ARE MADE TO YOUR MOTORCYCLE

**THIS KIT CONTAINS THE ITEMS PICTURED AND LABELLED BELOW.  
DO NOT PROCEED UNTIL YOU ARE SURE ALL PARTS ARE PRESENT.**

**Please note that the way the kit is packed does not necessarily represent the way of mounting to the bike**

THE PARTS SHOWN MAY BE REPRESENTATIVE ONLY (FOR CLARITY OF INSTRUCTIONS ONLY)

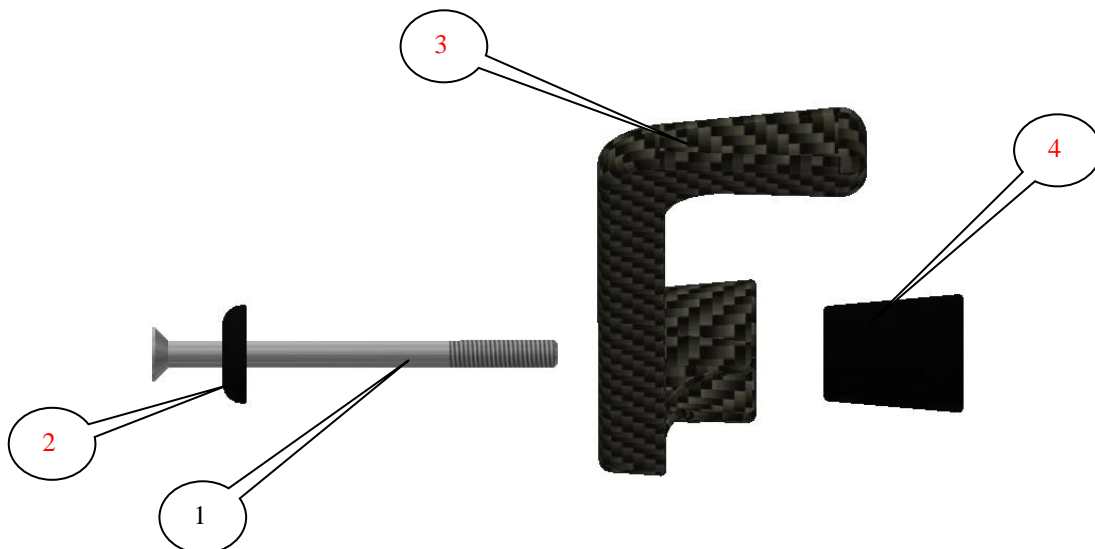

**R&G Racing**

Unit 1 Shelleys Lane, East Worldham, Alton, Hants GU34 3AQ

Tel: +44 (0)1420 89007 Fax: +44 (0)1420 87301 [www.rg-racing.com](http://www.rg-racing.com) Email: [info@rg-racing.com](mailto:info@rg-racing.com)

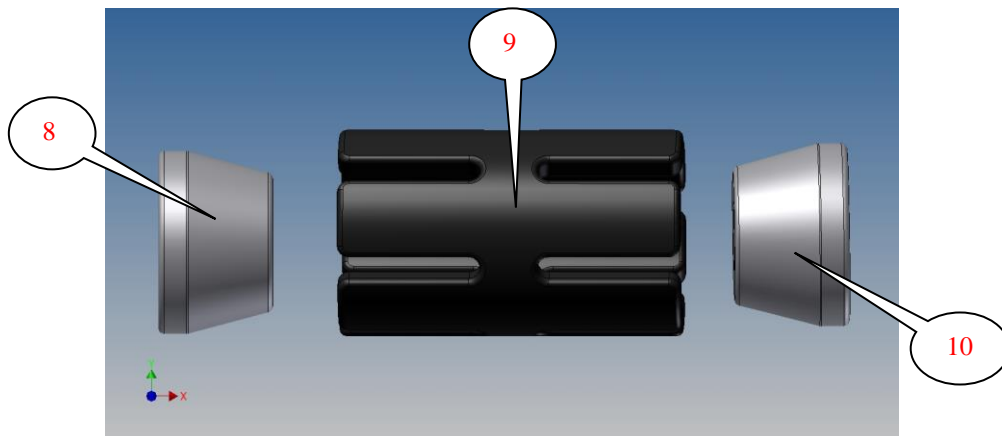
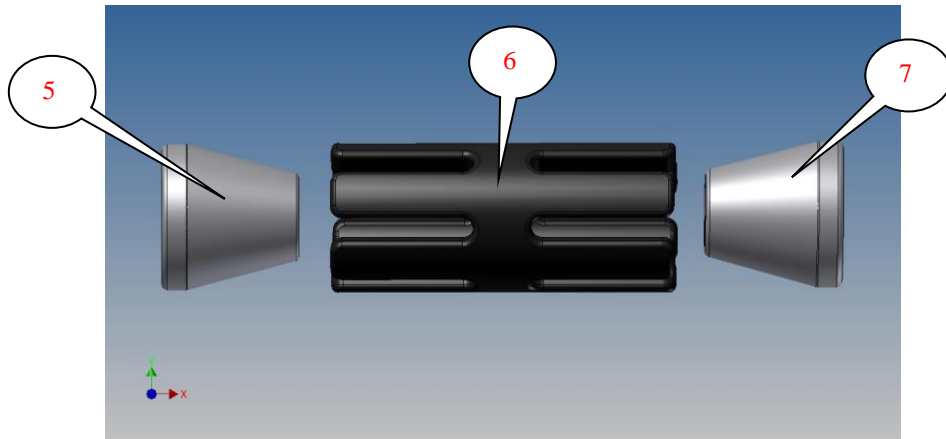

### **LEGEND**

- ITEM 1 = M6x90mm LONG COUNTER-SUNK BOLT (x1).
- ITEM 2 = CLAMP SPACER (S0928) (x1).
- ITEM 3 = CARBON FIBRE LEVER GUARD (NOT INCLUDED IN FITTING KIT) (LG0001).
- ITEM 4 = LARGE CONE SPACER (S0781) (x1).
- ITEM 5 = SMALLEST TAPERED SPACER (S0840) (x1).
- ITEM 6 = SMALLEST EXPANDING SPACER (S0838) (x1).
- ITEM 7 = SMALLEST TAPERED NUT (H0055) (x1).
- ITEM 8 = LARGEST EXPANDING SPACER (S0839) (x1).
- ITEM 9 = LARGEST TAPERED SPACER (S0841) (x1).
- ITEM 10 = LARGEST TAPERED NUT (H0056) (x1).

### **TOOLS REQUIRED**

- Set of Allen keys to include 4mm A/F.
- Whatever tools required to remove original bar-end if applicable.
- 

### **FITTING INSTRUCTIONS**

- To fit the Lever Guard remove the original bar end.
- Place the counter-sunk bolt (item 1) through domed counter-sunk spacer (item 2) and then through the Lever Guard so the domed spacer sits against fixed spacer in the Lever Guard.

### **R&G Racing**

Unit 1 Shelleys Lane, East Worldham, Alton, Hants GU34 3AQ

Tel: +44 (0)1420 89007 Fax: +44 (0)1420 87301 [www.rg-racing.com](http://www.rg-racing.com) Email: [info@rg-racing.com](mailto:info@rg-racing.com)



- Place the largest cone spacer over the thread and into the Lever Guard.

**If bars are between 13-18mm internal diameter**

- Place the smallest (unthreaded) tapered spacer (item 5) over the exposed thread (so it sits against the large cone spacer just fitted).
- Place the smallest expander (item 6) over the exposed thread (so it sits against the smallest tapered spacer just fitted).
- Place the smallest tapered nut (item 7) onto the thread and engage until it locates in the expander just fitted.
- Locate the assembly into the bar and position so when the motorcycle is at full lock in both directions it does not contact any other part of the motorcycle.
- Fully tighten the bolt and check operation.

**If bars are between 18-21mm internal diameter**

- Place the largest (unthreaded) tapered spacer (item 9) over the exposed thread (so it sits against the large cone spacer just fitted to the Lever Guard).
- Place the largest expander (item 8) over the exposed thread (so it sits against the tapered spacer just fitted).
- Place the largest tapered nut (item 10) onto the thread and engage until it locates in the expander just fitted.
- Locate the assembly into the bar and position so when the motorcycle is at full lock in both directions it does not contact any other part of the motorcycle.
- Fully tighten the bolt and check operation.

**IMPORTANT**:- WHEN FITTING THIS PRODUCT IT IS YOUR RESPONSIBILITY TO ENSURE THAT THE PRODUCT IN NO WAY IMPEDES THE OPERATION OF THE MOTOR CYCLE AND IS CHECKED REGULARLY FOR TIGHTNESS AND OPERATION.

FAILURE TO CHECK THE ABOVE COULD RESULT IN SERIOUS INJURY OR DAMAGE.

**Digital copies of these instructions are available to download from [www.rg-racing.com](http://www.rg-racing.com)**

ISSUE 2 18/01/2016 (NSY)

**CONSUMER NOTICE**

The catalogue description and any exhibition of samples are only broad indications of the Products and R&G may make design changes which do not diminish their performance or visual appeal and supplying them in such state shall conform to the order. The Buyer acknowledges no representation or warranty (other than as to title) has been given or will apply to the Products other than those in R&G's order or confirmation and the Buyer confirms it has chosen the Products as being of merchantable quality and suitable for its particular purposes. Where R&G fits the Products or undertakes other services it shall exercise reasonable skill and care and rectify any fault free of charge unless the workmanship has been disturbed. The Buyer is responsible for ensuring that the warranty on the motorcycle is not affected by the fitting of the Products. On return of any defective Products R&G shall at its option either supply a replacement or refund the purchase money but shall not be liable if the Products have been modified or used or maintained otherwise than in accordance with R&G's or manufacturer's instructions and good engineering practice or if the defect arises from accident or neglect. Other than identified above and subject to R&G not limiting its liability for causing death and personal injury, it shall not be liable for indirect or consequential loss and otherwise its liability shall be limited to the amounts paid by the Buyer for the Products or the fitting or service concerned. These terms do not affect the Buyer's statutory rights.

**R&G RACING RETURNS POLICY (NON-FAULTY GOODS)**

Returns must be pre-authorised (if not pre-authorised the return will be rejected). Goods may only be returned direct to us if they were purchased direct from us (customer must prove if necessary). Otherwise to be returned to original vendor. Goods must be in re-sellable condition, in the opinion of R&G Racing. All returns are subject to a 25% restocking and handling fee (25% of the gross value exc. P&P – at the prevailing price at time of purchase). The customer must pay any and all carriage charges. No returns of discontinued products, unless within 14 days of purchase. This policy does not affect your statutory rights and does not refer to faulty goods.

**R&G Racing**

Unit 1 Shelleys Lane, East Worldham, Alton, Hants GU34 3AQ

Tel: +44 (0)1420 89007 Fax: +44 (0)1420 87301 [www.rg-racing.com](http://www.rg-racing.com) Email: [info@rg-racing.com](mailto:info@rg-racing.com)



**INSTRUCTIONS DE MONTAGE POUR LGFK0001 PROTECTION POIGNEE**  
**Pour monter sur un guidon creux avec un diamètre interne de 13-21mm**  
**uniquement**

Page | 4



SVP ASSUREZ VOUS QUE LE PRODUIT EST COMPATIBLE AVANT D'ENLEVER OU DE MODIFIER QUELCONQUE PARTIE SUR LA MOTO

**Le kit contient les articles exposés ci-dessous, vérifier que toutes les pièces soient présentes avant de procéder au montage.**

**La façon dont le kit est emballé ne correspond pas forcément à la façon de monter les pièces sur la moto.**

**LES PARTIES PRESENTEES PEUVENT ETRE UNIQUEMENT REPRESENTATIVES (POUR LA CLARTE DES INSTRUCTIONS UNIQUEMENT)**

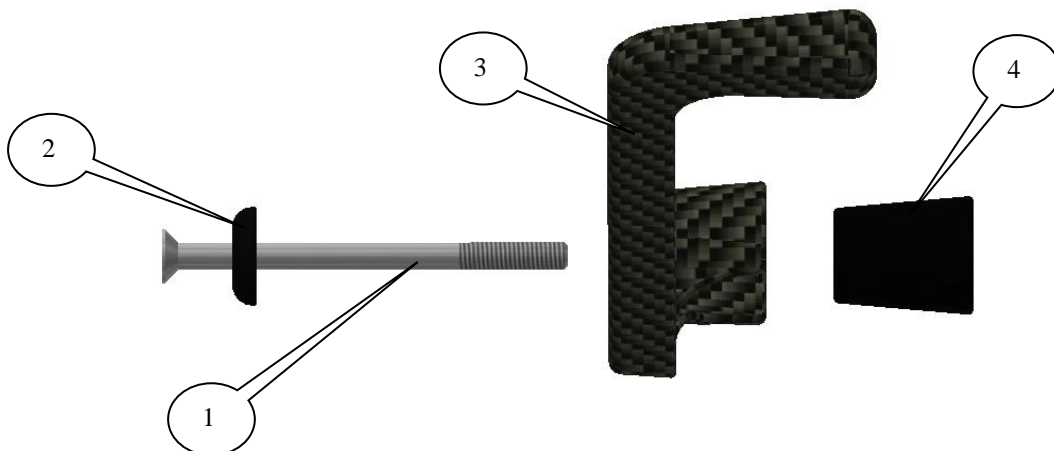

**R&G Racing**

Unit 1 Shelleys Lane, East Worldham, Alton, Hants GU34 3AQ

Tel: +44 (0)1420 89007 Fax: +44 (0)1420 87301 [www.rg-racing.com](http://www.rg-racing.com) Email: [info@rg-racing.com](mailto:info@rg-racing.com)

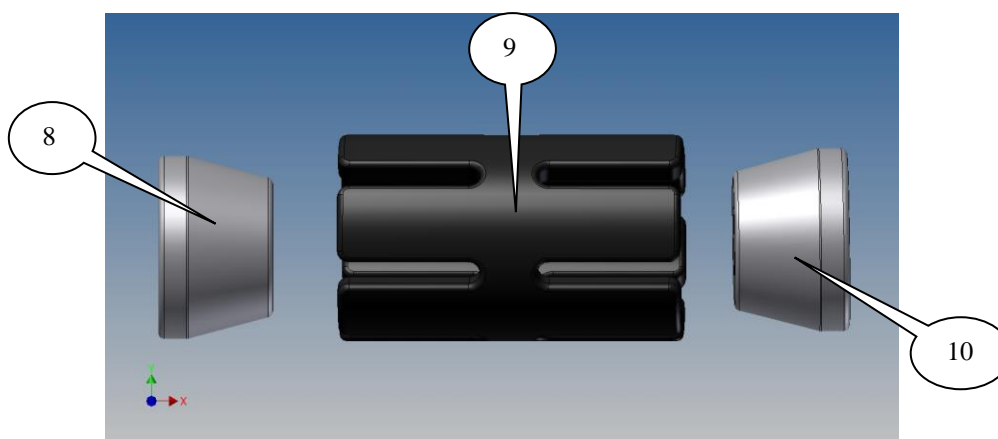
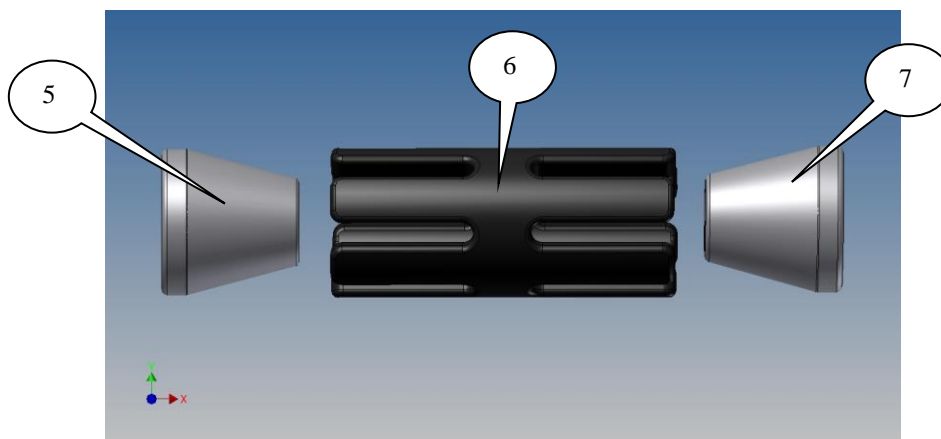

### **LEGENDE**

ARTICLE 1 = M6x90mm BOULON (x1).

ARTICLE 2 = ENTRETOISE (S0928) (x1).

ARTICLE 3 = PROTECTION POIGNEE EN FIBRE DE CARBONE (NON INCLUSE DANS LE KIT DE MONTAGE) (LG0001).

ARTICLE 4 = ENTRETOISE EN FORME DE CONE (S0781) (x1).

ARTICLE 5 = PETITE ENTRETOISE CONIQUE (S0840) (x1).

ARTICLE 6 = PETITE ENTRETOISE D'EXPANSION (S0838) (x1).

ARTICLE 7 = ECROU CONIQUE (H0055) (x1).

ARTICLE 8 = LARGE ENTRETOISE D'EXPANSION (S0839) (x1).

ARTICLE 9 = LARGE ENTRETOISE CONIQUE (S0841) (x1).

ARTICLE 10 = LARGE ECROU CONIQUE (H0056) (x1).

### **OUTILS REQUIS**

- Jeu de clés Allen 4mm.
- Quelconque outil capable d'enlever l'extrémité d'origine du guidon.

### **INSTRUCTIONS DE MONTAGE**

- Pour monter la protection poignée, retirer l'extrémité d'origine du guidon.

### **R&G Racing**

Unit 1 Shelleys Lane, East Worldham, Alton, Hants GU34 3AQ

Tel: +44 (0)1420 89007 Fax: +44 (0)1420 87301 [www.rg-racing.com](http://www.rg-racing.com) Email: [info@rg-racing.com](mailto:info@rg-racing.com)



- Placer le boulon (article 1) dans l'entretoise bombée (article 2) puis dans le garde levier afin que l'entretoise bombée se place contre l'entretoise fixée dans le garde levier.
- Placer l'entretoise conique la plus large sur le filetage et dans la protection poignée

**Si le guidon possède un diamètre interne de 13-18mm**

- Placer la plus petite entretoise conique (non filetée) (article 5) sur le filetage exposé (de façon à ce qu'elle se place contre l'entretoise conique large tout juste installée).
- Placer le plus petit expandeur (article 6) sur le filetage exposé (de façon à ce qu'il se place contre l'entretoise tout juste installée).
- Placer le plus petit écrou conique (article 7) sur le filetage et engager jusqu'à ce qu'il se place dans l'expandeur tout juste installé.
- Placer l'ensemble dans le guidon et positionnez-le de façon à ce qu'il ne puisse pas toucher quelconque partie de la moto lorsque le guidon est tourné au maximum à gauche et à droite.
- Serrer le boulon et vérifier que l'installation soit correctement installée.

**Si le guidon possède un diamètre interne de 18-21mm**

- Placer la plus grosse entretoise conique (non filetée) (article 9) sur le filetage exposé (de façon à ce qu'elle se place contre l'entretoise conique large tout juste installée sur la protection poignée).
- Placer le plus gros expandeur (article 8) sur le filetage exposé (de façon à ce qu'il se place contre l'entretoise conique tout juste installée).
- Placer le plus gros écrou conique (article 10) sur le filetage et engager jusqu'à ce qu'il se place dans l'expandeur tout juste installé.
- Placer l'ensemble dans le guidon et positionnez-le de façon à ce qu'il ne puisse pas toucher quelconque partie de la moto lorsque le guidon est tourné au maximum à gauche et à droite.
- Serrer le boulon et vérifier que l'installation soit correctement installée.

**IMPORTANT**:- LORSQUE VOUS INSTALLEZ CE PRODUIT, IL EST DE VOTRE RESPONSABILIT2 DE VEILLER A CE QU'EN AUCUN CAS LE PRODUIT NE PUISSE ALTERER NI LE FONCTIONNEMENT DE LA MOTO NI SON PILOTAGE.

VERIFIEZ REGULIEREMENT LE SERRAGE DES PROTECTIONS ET.

NE PAS EFFECTUER CETTE VERIFICATION PEUT ENGENDRER DE SERIEUX DOMMAGES ET BLESSURES DU PILOTE.

**Ces instructions de montage sont disponibles sur [www.rg-racing.com](http://www.rg-racing.com)**

ISSUE 2 18/01/2016 (NSY)

**CONSUMER NOTICE**

The catalogue description and any exhibition of samples are only broad indications of the Products and R&G may make design changes which do not diminish their performance or visual appeal and supplying them in such state shall conform to the order. The Buyer acknowledges no representation or warranty (other than as to title) has been given or will apply to the Products other than those in R&G's order or confirmation and the Buyer confirms it has chosen the Products as being of merchantable quality and suitable for its particular purposes. Where R&G fits the Products or undertakes other services it shall exercise reasonable skill and care and rectify any fault free of charge unless the workmanship has been disturbed. The Buyer is responsible for ensuring that the warranty on the motorcycle is not affected by the fitting of the Products. On return of any defective Products R&G shall at its option either supply a replacement or refund the purchase money but shall not be liable if the Products have been modified or used or maintained otherwise than in accordance with R&G's or manufacturer's instructions and good engineering practice or if the defect arises from accident or neglect. Other than identified above and subject to R&G not limiting its liability for causing death and personal injury, it shall not be liable for indirect or consequential loss and otherwise its liability shall be limited to the amounts paid by the Buyer for the Products or the fitting or service concerned. These terms do not affect the Buyer's statutory rights.

**R&G Racing**

Unit 1 Shelleys Lane, East Worldham, Alton, Hants GU34 3AQ

Tel: +44 (0)1420 89007 Fax: +44 (0)1420 87301 [www.rg-racing.com](http://www.rg-racing.com) Email: [info@rg-racing.com](mailto:info@rg-racing.com)





**R&G RACING RETURNS POLICY (NON-FAULTY GOODS)**

Returns must be pre-authorized (if not pre-authorized the return will be rejected). Goods may only be returned direct to us if they were purchased direct from us (customer must prove if necessary). Otherwise to be returned to original vendor. Goods must be in re-sellable condition, in the opinion of R&G Racing. All returns are subject to a 25% restocking and handling fee (25% of the gross value exc. P&P – at the prevailing price at time of purchase). The customer must pay any and all carriage charges. No returns of discontinued products, unless within 14 days of purchase. This policy does not affect your statutory rights and does not refer to faulty goods.